

# FIRE SPRINKLER PRODUCTS

Residential Manifold *Riser*

DN25 – DN32

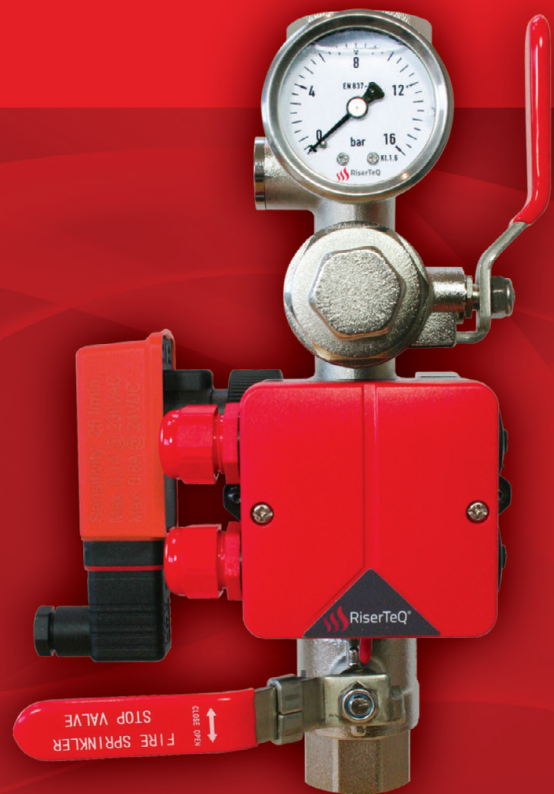

# ABOUT THE RMR



## Residential Fire Sprinkler valve set

*Designed according to:*

BS 9251:2021 & EN 16925:2018

*Utilising only:*

EN 12259-5 LPCB Flow Switches

**RiserTeQ** fire sprinkler products are designed with a holistic approach giving a highly functional purpose also proving full compliance. Our solutions are fit for purpose along with key advantages. This design ethos enables us to provide both user and installer with products which remove historic and problematic faults while providing features which reduce installation and commissioning time. At every phase of the design, testing and manufacturing process, **RiserTeQ** manifold valve sets focus on reliability with an emphasis on quality.

### One piece forging – 30% less leak paths

The **RMR**, the worlds first Residential Manifold Riser valve set designed with the premise that a Valve Monitor could be required due to EN 16925:2018. This Cat 2, 3 & 4 application solution features a patent pending design which offers a unique single piece forging and therefore limits leak paths and reduces product failure risk.

The unique forging design allows for a robust and reliable Valve Monitor installation, whilst allowing the manifold valve set to perform as normal. This provides confidence for both the installation/commissioning and the end client. All **RiserTeQ** manifold products only use Flow Alarms approved to EN 12259-5 which are LPCB certified.

### Category 2, 3 & 4 Installations: Residential and Carehome premises

- ✓ World's first one piece forging design
- ✓ Forging allows for Valve Monitor
- ✓ Compact installation and operation
- ✓ Reduced leak risk by 30%
- ✓ Patent pending



## RMR Manifold Features

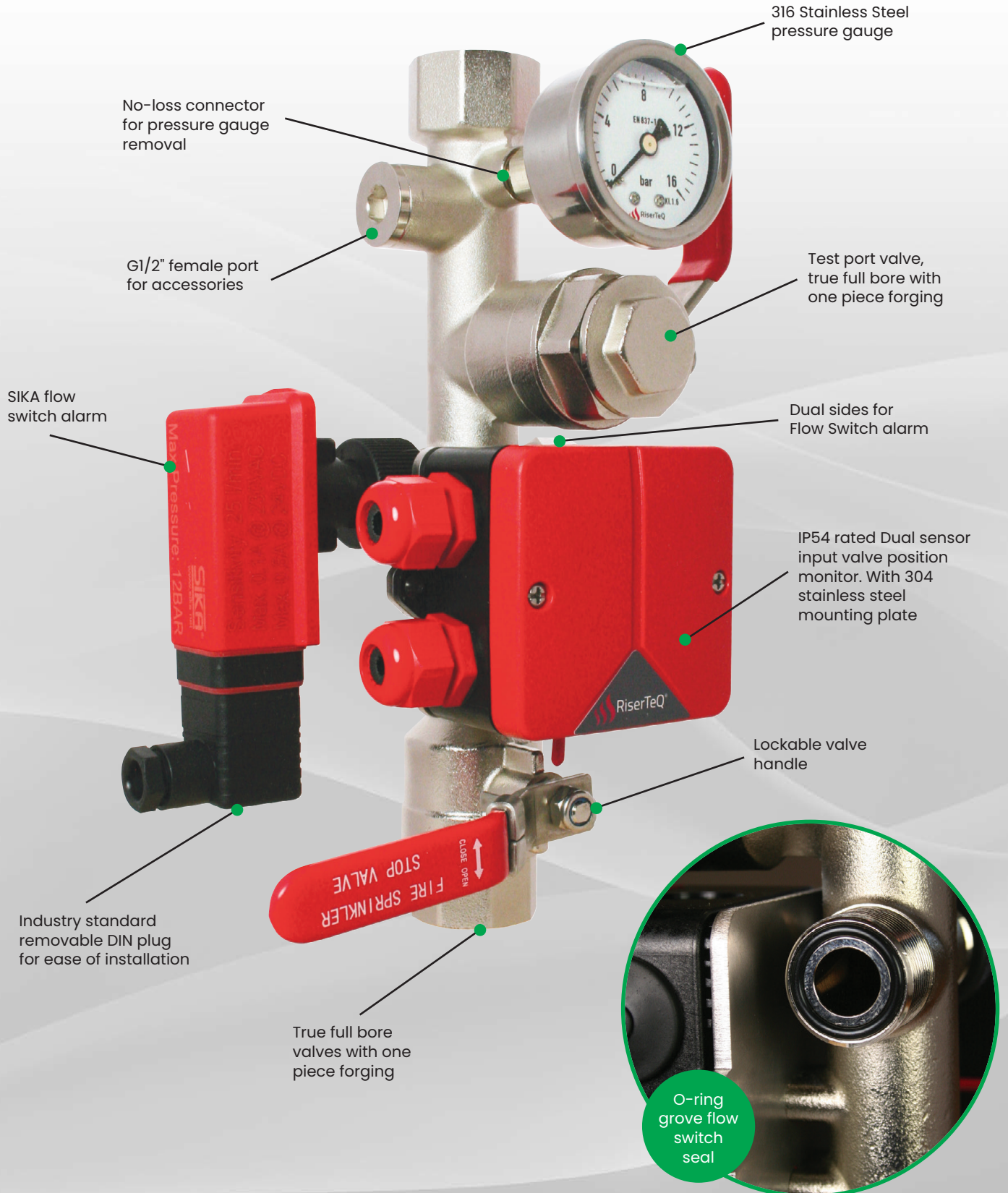

## RMR Technical Data

Manifold		
Size	DN25	DN32
Inlet Connection	Female G1"	Female G1 1/4"
Outlet Connection	Female G1"	Female G1 1/4"
Test Point Connection	Female G1"	Female G1"
Medium	Water	Water
Medium Temperature	5...50 °C	5...50 °C
Ambient Temperature	5...60 °C	5...60 °C
Max Pressure Rating	12 bar	12 bar
Inlet Valve Internal Bore	DN25	DN32
Test Point Valve Internal Bore	DN25	DN32

Valve Monitor	
Cable Entries	2 x M20 Cable Glands - IP66 / 2 x Rubber Glands - IP66
EOL Resister Input	Yes
Flow Switch/Alarm Resister Input	Yes
Connector Type for Resisters	Removable 2 Pin
Ingress Protection	IP54
Maximum Voltage	24VDC

Pressure Gauge	
Size	50mm
Pressure Range	0-16 Bar
Accuracy	1.6 FSD
Standard	EN 837-1
Pressure Scale	0.5 Bar
Pressure Connection	G1/4"
Medium Temperature	5...50 °C

No-Loss Connector	
Max Pressure	16 bar
Medium Temperature	5...50 °C
Process Connections	G1/4" x 1/4" BSPT

## RMR Pressure Loss Data

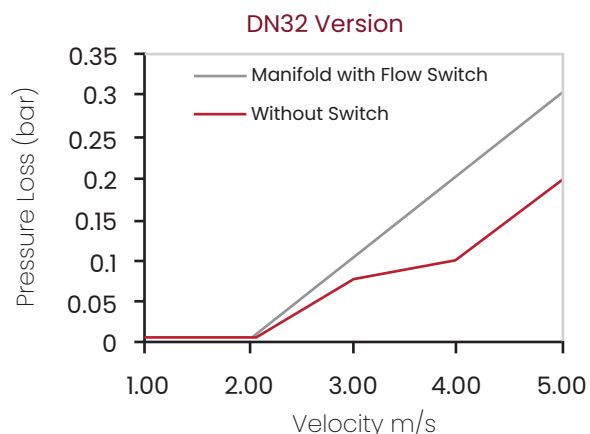
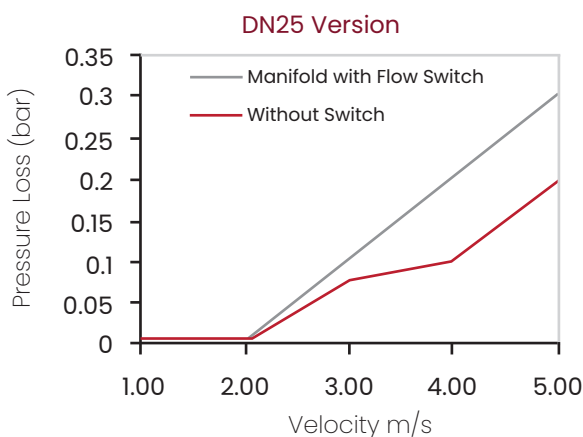

## VKF Flow Switch

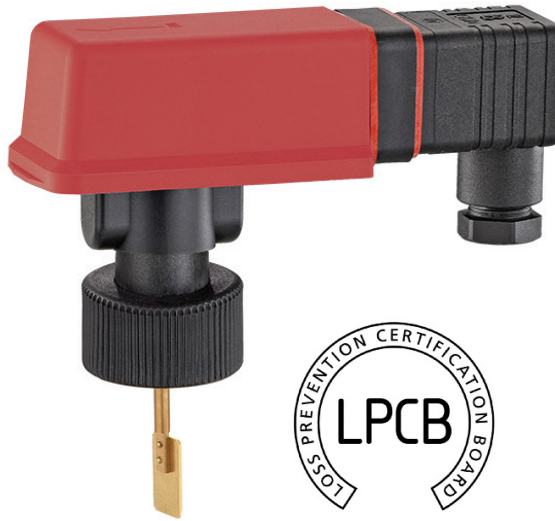

[Click for Certificate](#)

Flow Switch proudly produced by SIKA

VKF Flow Switch		
Model	VKF25 M2 BRASS	VKF32 M2 BRASS
For RiserTeQ™ Valve set Size	DN25	DN32
Max pressure rating	12 Bar	12 Bar
Medium temperature	-25... 100 °C	-25... 100 °C
Ambient temperature	-25... 70 °C	-25... 70 °C
Setpoint (Sensitivity)	25 L/min*	26 L/min*
Maximum Surge	5,5 m/s	5,5 m/s
Medium	Water	Water
Electrical Specification		
Electrical Connection	Plug connector DN EN 175301-803-A inc. cable socket	
Switch Type	1 x SPST	
Electrical Rating	Max. 26 VA, 20W	
Switching Voltage	Max. 230 VAC, 48 VDC	
Maximum Rated Current @ 230 VAC	0,1 A	
Maximum Rated Current @ 24 VDC	0,8 A	
Minimum Rated Current	1 mA	
Ingress Protection	IP65	
Protection class (EN 60730-1)	Class II	
Materials of Construction		
Body / Holder	PPE+PS Noryl™ 30% GF	
Paddle System / Disk / Rivet	BRASS (CW614N, CW508L)	
Axis	Stainless Steel 1,4571	
Magnet	Hard Ferrite	

\* Water @ 20°C, Vertical Pipe (Flow Direction Upwards). Tolerance +/-15%. Must be installed according to the manual.

### VKF Approvals



## Dimensions

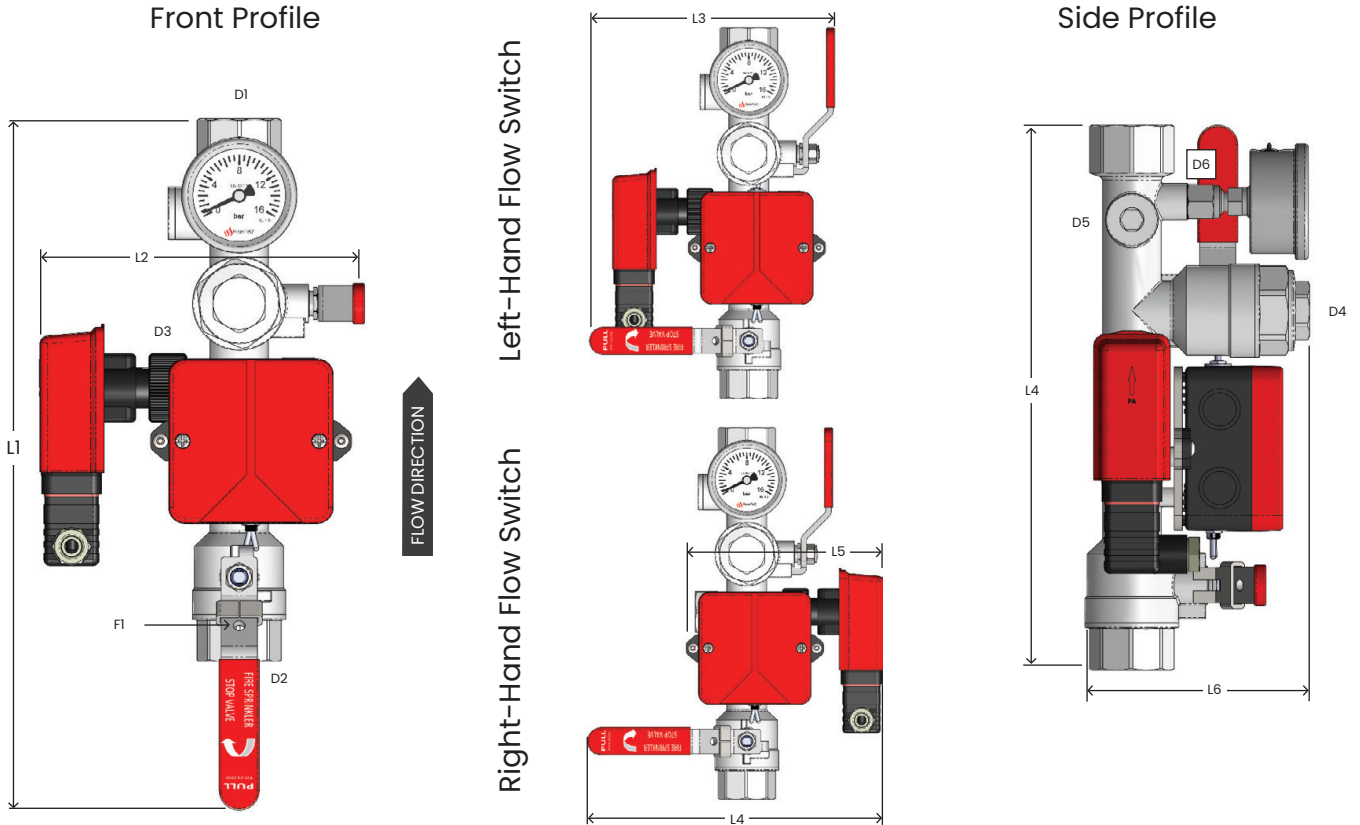

Type	L1	L2	L3	L4	L5	L6	D1	D2	D3	D4	D5	D6	F1
<b>RMR-25</b>	344.5	162	178.5	215	143.5	112	1" BSPP ISO 228	1" BSPP ISO 228	G3/4" ISO 228	1" BSPP ISO 228	G1/2"	G1/4"	ø6
<b>RMR-32</b>	350	164	178.5	218	151	117	1" BSPP ISO 228	1" BSPP ISO 228	G3/4" ISO 228	1" BSPP ISO 228	G1/2"	G1/4"	ø6

## Materials of Construction

Manifold	
Body	Brass CW617N Nickel plate
Seals	PTFE and NBR (HA70)
Inlet Valve Locking Handle	316 SS
Blanking Cap	Brass CW617N Nickel plate
Test Valve Cap	316 SS
Accessory Port Plug and Seal	Brass CW617N Nickel plate + PTFE
Valve Monitor	
Casing	ABS
Mounting Plate	316 SS
Pressure Gauge	
Outer Case and Process Connection	304 SS
Bourdon Tube	316 SS
Window	Polycarbonate

## Part Number Building

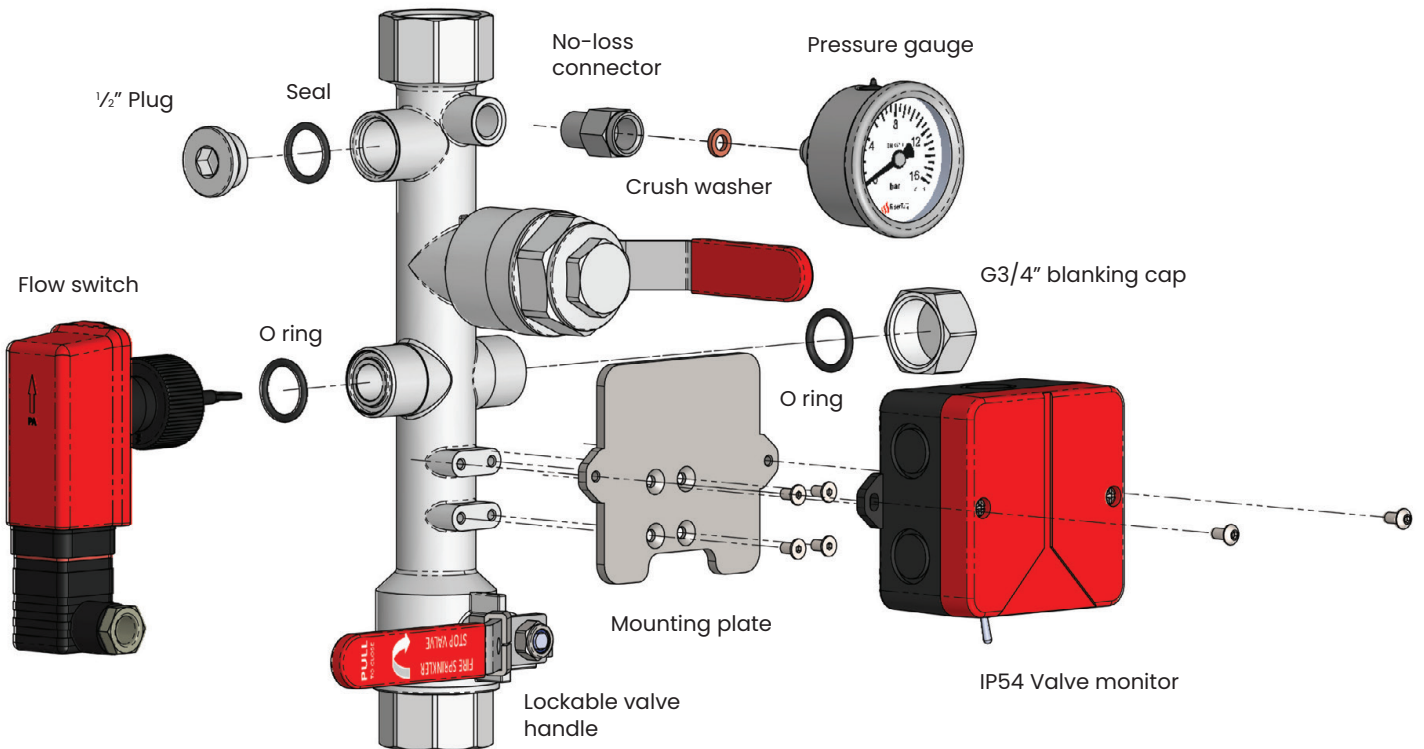

Order Code							
<b>Type</b>							
Residential Manifold Riser	RMR						
<b>Size DN</b>							
DN-25	25						
DN-32	32						
<b>Flow Switch</b>							
DN-25 Metal Paddle	VKF25M						
DN-32 Metal Paddle	VKF32M						
DN-32 Plastic Paddle	VKF32P						
No Switch	00000X						
<b>Pressure Gauge</b>							
0-16 Bar							PG1
Special							PGX
<b>No-Loss Connector</b>							
With							NL
Without							NB
<b>Valve Monitor</b>							
With							RVM
Without							00X
<b>Custom Options</b>							
No Options							2000
<b>Example Order Number</b>	RMR	32	VK32M	PG	NL	RVM	2000



**RiserTeQ Limited**  
8 Astley House  
Cromwell Business Park  
Oxfordshire  
OX7 5SR

[www.RISERTEQ.com](http://www.RISERTEQ.com) | [sales@RISERTEQ.com](mailto:sales@RISERTEQ.com)